

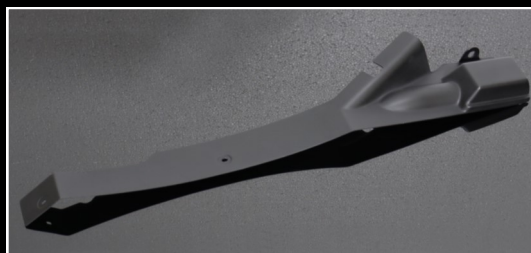

MAKING YOUR DREAMS A REALITY

FITTING INSTRUCTIONS

**Cutting the coolant hose to fit BPFC-7049R/BPCC-7049R
Frame In-Fill Panel, Right, RC36-2, RC30 Style**



To fit the BPFC/BPCC-7049R In-fill on the VFR750F RC36-2, it is required that the coolant hose that runs from the thermostat housing to the top right spigot on the radiator is shortened by 10~15mm.

Tools required are a very sharp knife, and non-cut gloves are also a good idea so that you start and finish the job without cutting your fingers!

It's best to start this job with the bike with no bodywork fitted so that you have good access to all the components, and it's preferable that the complete cowling stay kit has already been fitted and setup for your RC36-2, RC30 style upper cowling and lower cowling. Then we know that the stays are all in the correct place and that when the coolant hose has been adjusted and fitted, that it is not interfering with any of the stays.

Fitting instructions for the cowling stays can be found in the
fairing stays fitting manual TYBP-0006

Please follow the instructions below.

1) Drain the coolant. The coolant drain bolt is on the lower left side on the bike on the water pump cover.

2) Remove the coolant hose. There are two hose clamps. Note that in these instructions we only cut the end that attaches onto the spigot on the radiator end. However, I advise to do the cutting in small steps at a time, as maybe cutting a short amount off both ends will work for your application.

3) At this point, it's worth checking that the stay that holds and locates the thermostat housing is not bent. In its original state, the stay is flat. On our bike, the stay was seriously bent, so we just flattened it back to what it should be



4) To cut the hose, my chosen method is to semi tighten the original hose clamp at the required place where I want to cut. Make sure that the hose clamp is parallel to the end all the way around, and then use the hose clamp as a guide. Note that the hose is not easy to cut through, so be patient, and keep your fingers out of the way!

It's best to cut in small increments. I removed 10mm from the radiator end with the first cut, fitted the hose and the in-fill and tested for interference. I then removed another 5mm from the radiator end to get the clearance I needed .



5) You are looking to have the hose clear of the in-fill, and to also clear the BPSY-0366 Right hand, mid cowling stay. You may have to twist the orientation of the hose a little on the spigots to get the perfect routing with no interference. Please be patient, as it is possible. On our bike I just had to rotate the hose where it fits to the spigot on the thermostat housing a couple of degrees in the clockwise direction. Keep retesting with the in-fill and upper cowling and you'll get there in the end.